



**Tewantin, QLD**  
28 Saint Andrews Drive

**3** BED  
**2** BATH  
**1** CAR

**HANGloosa**  
property noosa

Welcome to The Ranch...

When you walk into this beautiful home you immediately feel a sense of warmth and comfort, and a feel for what it could be. Rich in character and commanding an elevated position with two street frontages, this family residence holds immense potential for any purchaser. Superbly located with schools, day-care, a bustling shopping complex and an 18 hole golf course all within walking distance.

Three large bedrooms all with built-ins and bathrooms located both upstairs and down, the layout is spacious and family friendly. Charming raked cathedral ceilings throughout create an abundance of natural light filled interiors. Located in the middle of the house, the kitchen is rustic and full of character, bench space and storage. There is a bonus of an additional room off the living area, ideal as a study, studio or sunroom.

**Offers Over \$499,000**

**View:** Sat, 20 Jan 2018 @10:00 am - 10:45 am  
Sat, 27 Jan 2018 @10:00 am - 10:45 am

**Contact:** Claire Reyne  
0423 984 404

**Type:** House

**Land:** 695m2

**<http://hangloosa.com.au>**

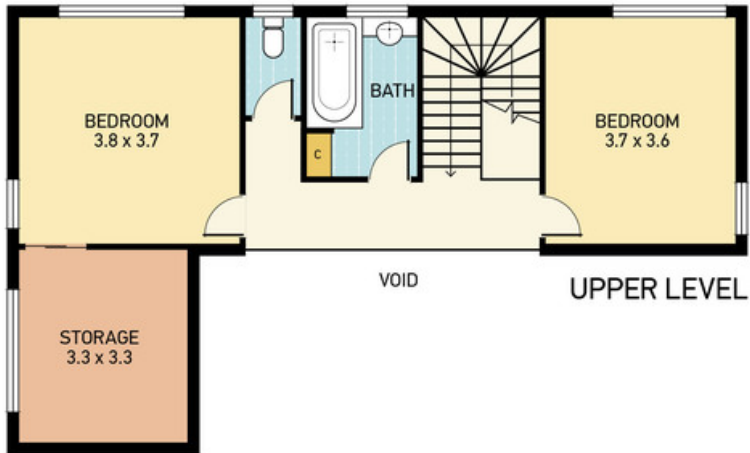

Total area: 164m<sup>2</sup> (approx.)  
 Internal area: 134m<sup>2</sup> (approx.)  
 Outdoor area: 14m<sup>2</sup> (approx.)  
 Garage: 16m<sup>2</sup> (approx.)



28 ST ANDREWS DR, TEWANTIN

DISCLAIMER: ALL DIMENSIONS ARE AN APPROXIMATION ONLY AND NO GUARANTEE IS GIVEN WITH RESPECT TO ACCURACY.

**HANGloosa**  
property noosa

Plans shown are only indicative of layout. Dimensions are approximate.

**Tewantin, QLD**  
28 Saint Andrews Drive